

13.88

Tuxedo
YACHTING HOUSE

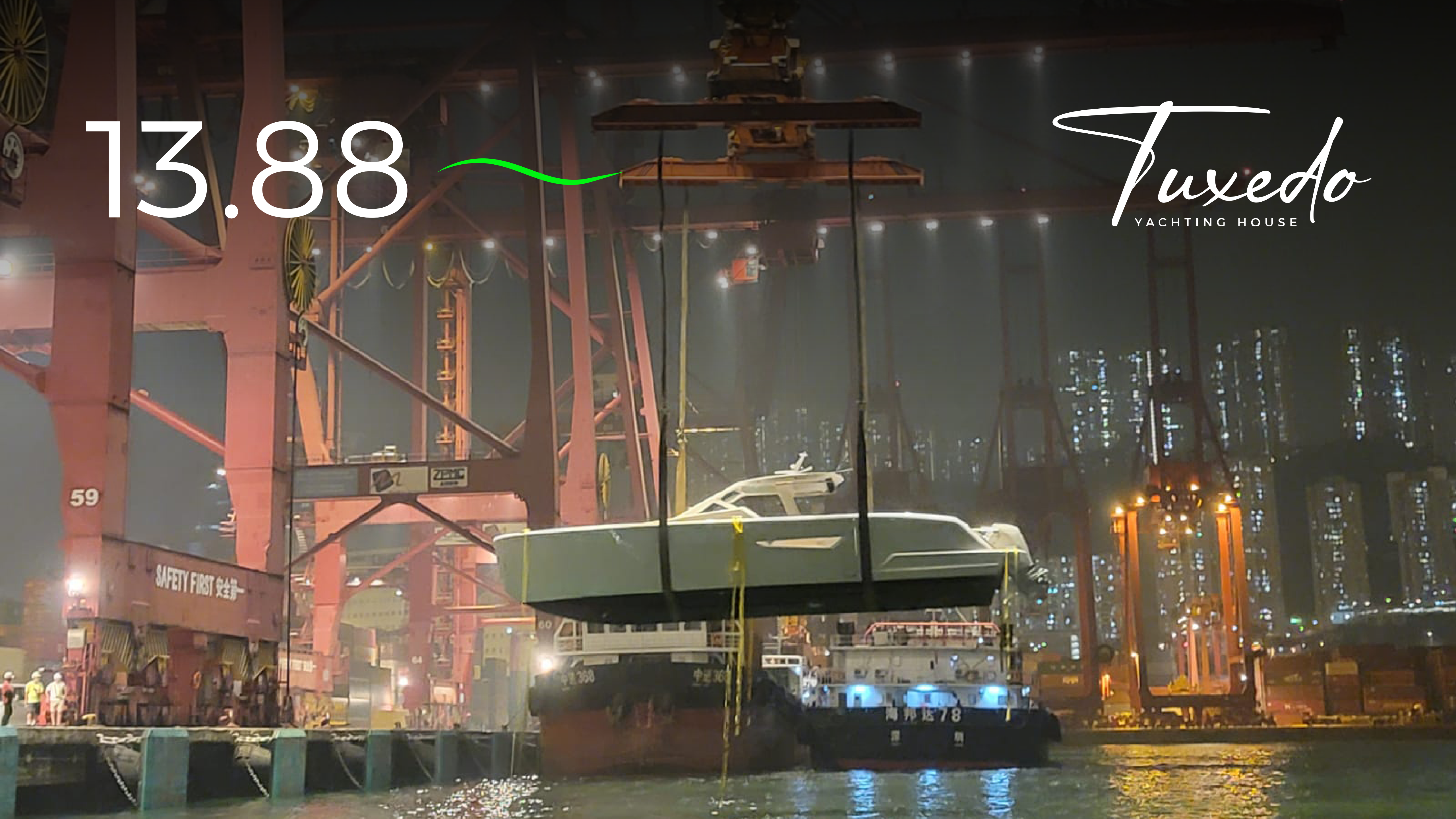

INDEX

The Tuxedo digital brochure is interactive. Please, use the index in this page to navigate all the sections and the menu symbol to step back to this page.

[Start the journey!](#)

The information and data contained in this brochure are not binding and have no contractual value. The Tuxedo Yachting House reserves the right to make changes without notice in order to ensure the continuous improvement of its products.



KNOW HOW
UNIQUENESS
PASSION
VALUE
SUSTAINABILITY

These are the concepts that inspire **Tuxedo Yachting House** in **designing** and **building boats**, so that every owner knowing what he wants can find his own boat. Might even want to explore the world of the possible until he finds what he wants. Because **nothing is more perfect than a desire**.

MADE IN ITALY

Born from a very precise idea that respects the principles of luxury craftsmanship, **Tuxedo Yachting House** translates the Italian character of the brand into unique pieces of great quality: the stylistic excellence of **Made in Italy** skilfully enhanced by the a 60-year boat building experience and aluminium hulls since **1982**.





EMOTIONS

We want the owner who turns to the **Tuxedo Yachting House** to find a way to have a familiar and intimate space with his boat, yet capable of surprising and arousing **strong emotions**, every day.

Able to meet the needs of everyone on board: the owner, his family, guests and crew, if any.

So that everyone can enjoy the benefits of cruising on a Tuxedo. Regardless of size. Because **pleasure is not measured in feet**.

TUXEDO BOUTIQUE

The **Tuxedo Yachting House** team specializes in building unique aluminium yachts with the know-how, care and class that distinguish great yachts. And with the same level of customization and care for the owner. Because it is in the very essence of the shipyard's raison d'être: to build mega-yachts and treat the owner accordingly even when building a 13-metre craft.

With the **Tuxedo Boutique** service, the owner is reached by the designers whenever and wherever he wishes. Respecting his privacy and his time. So that he can enjoy only the beauty of having a **custom-built yacht**.

Choosing Tuxedo means choosing your own boat and not any ordinary boat





ARTISAN BOATYARD

Essence resides in synthesis.

Tuxedo Yachting House likes simple lines that accommodate a distinct material character. For each space we identify its identity, interpreting it with elements capable of providing function and soul. With this approach, we discuss with the customer a proposal that may concern interior and exterior furnishings, highlighting the needs from the outset and articulating a project that develops from the central idea to after-sales.

Tuxedo Yachting House: the exclusivity that only an **artisan boatyard** can give, meeting the functional and aesthetic demands of the owner as no mass-produced boat ever can.

Seriality is not our first objective.

It is more logical and natural: those who are self-conscious and know what they are looking for, or even those who only know what they don't want, must be able to find what corresponds to them.

FLEXIBILITY

We chose **aluminium** because it allows us not to use moulds, which are necessary for fibreglass boats.

This allows us to modify every detail effortlessly, and to accommodate the legitimate decision changes of all the people involved in the process of choosing their next boat.

A path that is not always linear and that sometimes becomes defined just as the yacht takes shape.

Aluminium gives the owner this **flexibility** of choice, even while the boat is being built, without delays to normal construction and without the need to make new moulds and incur new costs.

Choosing a Tuxedo means embarking on a journey well before touching the water. Because it means choosing someone who has decided to build each boat together with its owner. This is why we work on small numbers. Because it is not the size that determines the attention we pay to the owner, because those who know how to choose are right to afford a Tuxedo.



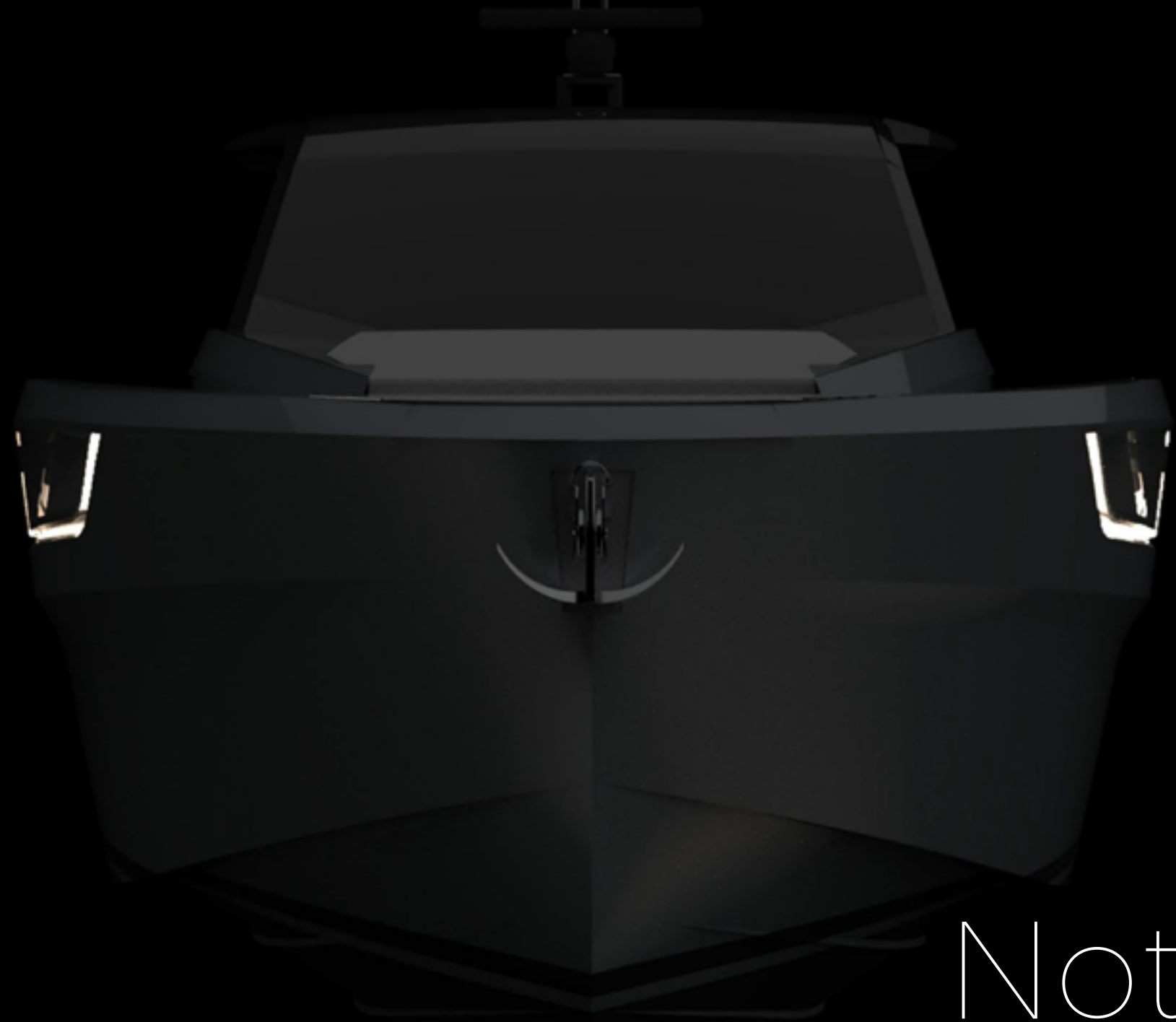

Nothing is more perfect
than a **desire**





Tuxedo

13.88

The exclusive **Tuxedo 13.88** is the result of a fruitful collaboration between siblings **Laura** and **Francesco Ceccarelli** with the **Agon studio** and designer **Lorenzo Berselli**. Customizable in every detail like every Tuxedo yacht, it has already been designed in two versions, **Black** and **Black Reverso**, different in appearance and character, but with the same genetic heritage.





PHILOSOPHY

Know How

It is only thanks to the know-how derived from an experience that goes well beyond half a century of yacht building that a **Tuxedo 13.88** can be what it is.

Choosing one can be certain that every design element, every construction detail and the entire end result is studied, optimized and made perfect.

It is the expertise born of practice and repetition and study that makes it possible to create unique pieces without having to pay the price of the first work.

Because **even a new and never-seen solution can only be built on what you know.**



EXCLUSIVITY

Uniqueness

In nature, not even twins are identical all the way through. The DNA is the same, but tastes, behaviour and expectations are different. So doesn't it make more sense to find the mirror of one's uniqueness even in something as personal as a boat? A **Tuxedo 13.88** is different from all others, even from another **Tuxedo 13.88**.

Its builder knows how to give its owner a truly bespoke, unique boat. To always stand out. The two **Black Tuxedo** and **Black Tuxedo Reverso** versions of the 13.88 show how the same content can have different shapes. The superstructure changes completely: more classic with the windscreen sloping towards the stern in the Black, more aggressive

with the windscreen upside down in the Black Reverso. There is no need to shout out your difference, you simply let it shine through with your presence. After all, the best synthesis of this was expressed in a phrase by a style icon like Coco Chanel: «**In order to be irreplaceable one must always be different**».

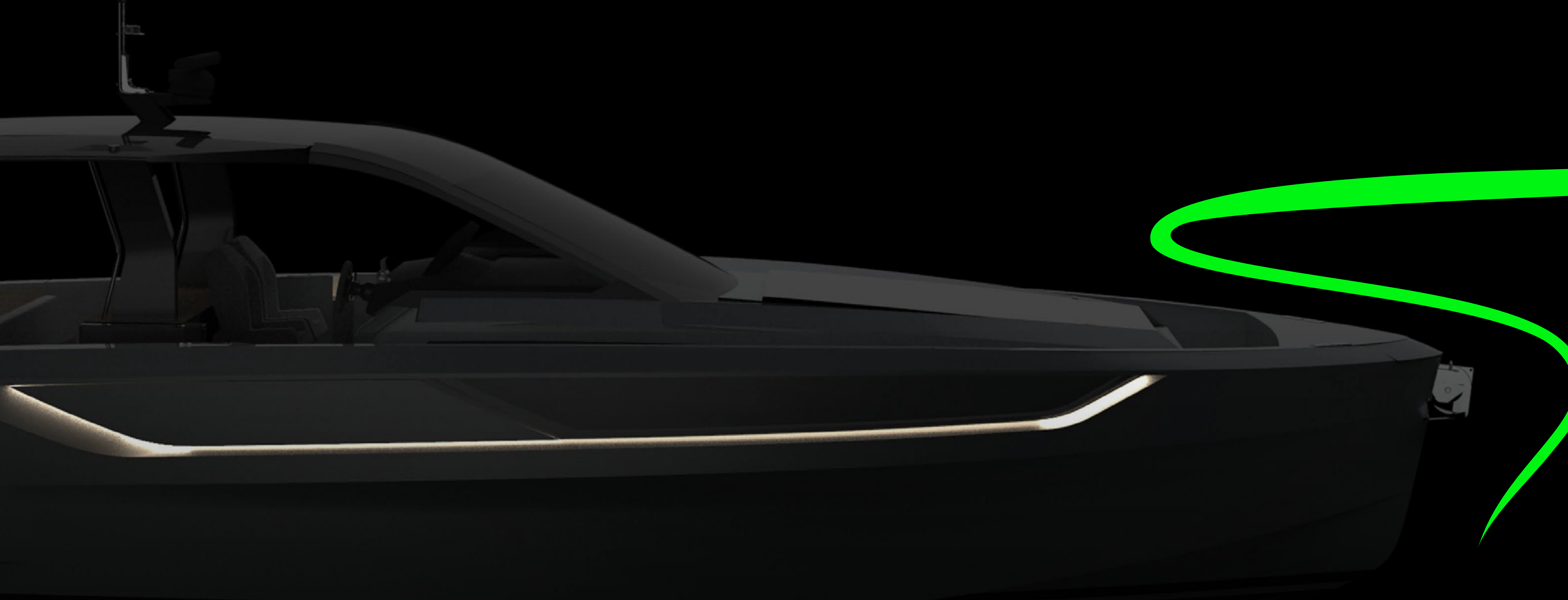

DEDICATION

Passion

Boats are not built because there's not better to do. Boats are not built because it's an easy market. Boats are not built because they're easy items. **Boats are built because there's a burning passion** for the item, for the sea and for all those who decide to sail it.

One-offs like every **Tuxedo 13.88** are not built because it's more convenient: it's much more complex than moulding a mass-produced yacht. Building literally piece by piece requires much more **skill** and **dedication**,

but ours is a voluntary and conscious choice, because what moves us is the desire to satisfy all those who have finally found what until now only existed in their desires, their **Tuxedo 13.88**.



GUARANTEE

Value

Sure, the materials with which a **Tuxedo 13.88** is made are one aspect, of its value. And they are so in the hull and the deck, as well as in the furnishings, the upholstery. And the value of a **Tuxedo 13.88** also lies in its naval architecture, in the efficiency of the water lines that make it capable of reaching a maximum speed of **40 knots** in total safety even in harsh weather and sea conditions. The value also lies in the increased durability of the hull guaranteed by the thickness of the **aluminium** sheets used in its construction. It is in the safety provided by a **fireproof material** that deforms rather than breaks in the event of impact. But the supreme value is its absolute excellence of interiors and exteriors. Nothing is defined or binding, everything is left to the discretion of the owner.

One or two **cabins**, one or two **heads, open space** or **separate rooms, indoor** or **outdoor galley**, a **superstructure** enclosing the **cockpit** or an **open hard top**... It doesn't matter whether you want shaft drive propulsion or, as in the first unit launched, **outboard engines** or even **hybrid solutions**. Because a family with children, a close-knit couple or a group of friends have different needs and it is right that they should all be heard. Because on a **Tuxedo 13.88** nobody has to give up something they consider indispensable: an **absolute value like their own well-being**.

ALUMINIUM

Sustainability

Being mindful of the footprint we leave with our choices is much more than sticking green labels on something. A **Tuxedo 13.88**, thanks to its aluminium, does not release volatile substances during construction. It does not require the creation of moulds, made of plastic, which will eventually be thrown away.

Even machining scraps are collected and reused in other industrial processes, unlike the leftovers of mass-produced industrial constructions. And then a **Tuxedo 13.88** is sustainable because even though it can reach 40 knots its hull is designed to travel efficiently even at low speeds, to enjoy the sea and the voyage while at the same time reducing fuel consumption and hence greenhouse gas emissions.

And even at the end of its life a Tuxedo leaves a lighter footprint, because as a whole it is **over 90% recyclable**, and no other traditional material guarantees these results. Not even wood.



Nothing is more perfect
than a **desire**



BLACK TUXEDO 13.88

Technical Data

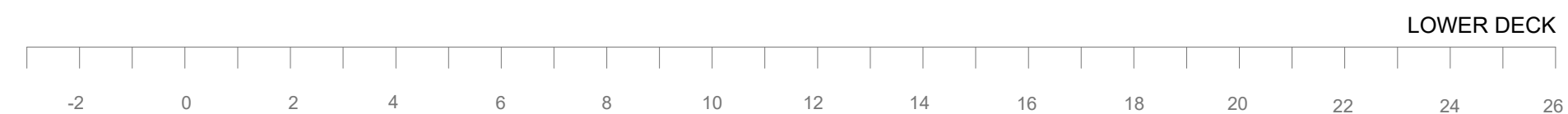
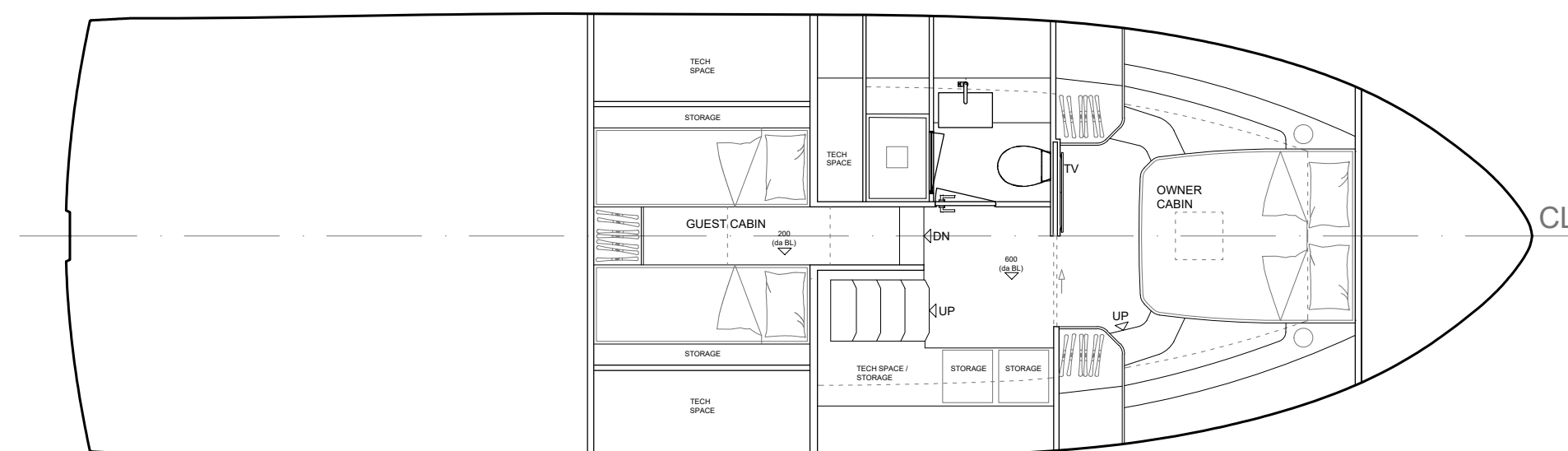
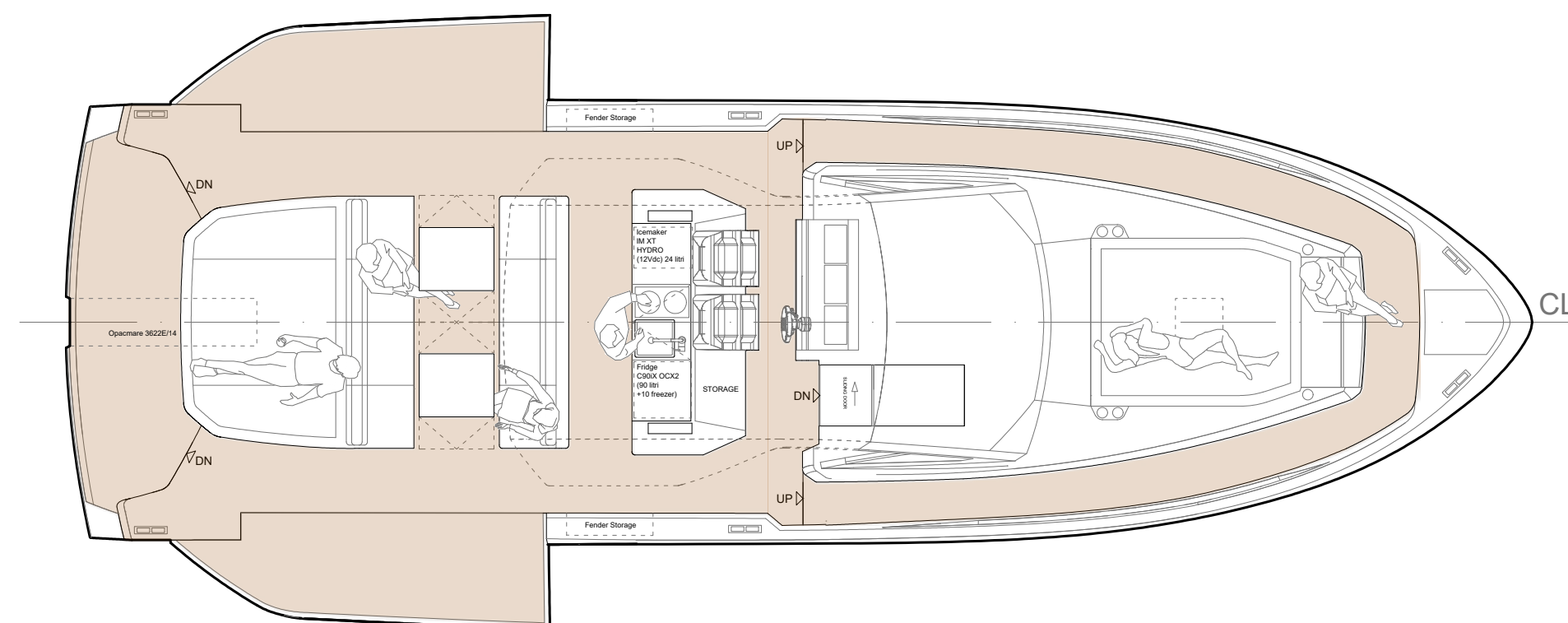
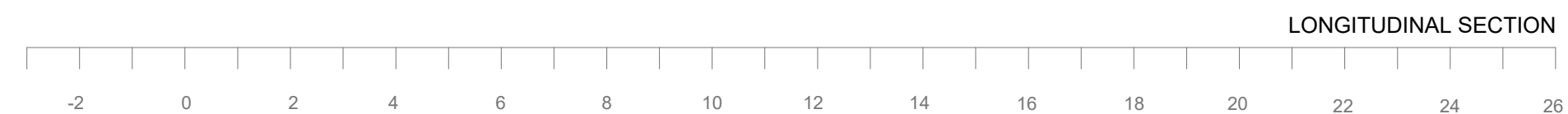
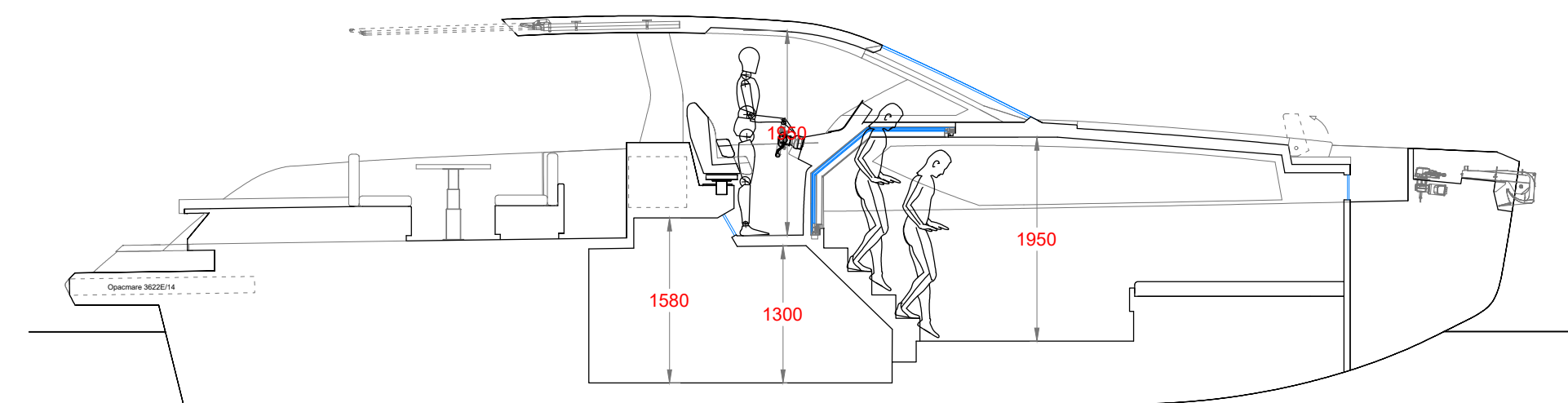

BLACK TUXEDO REVERSO 13.88

Technical Data

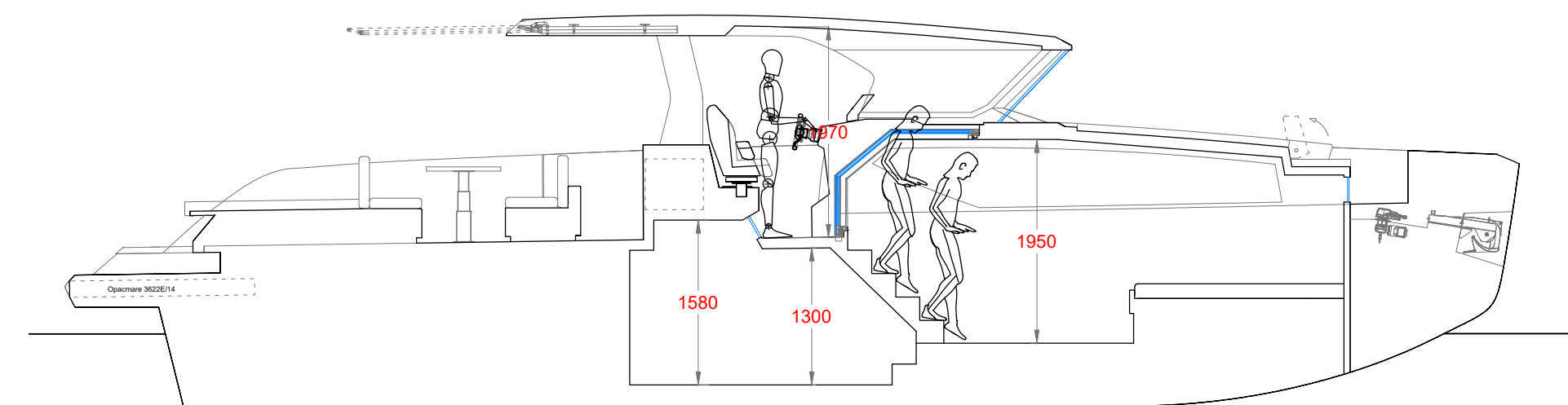
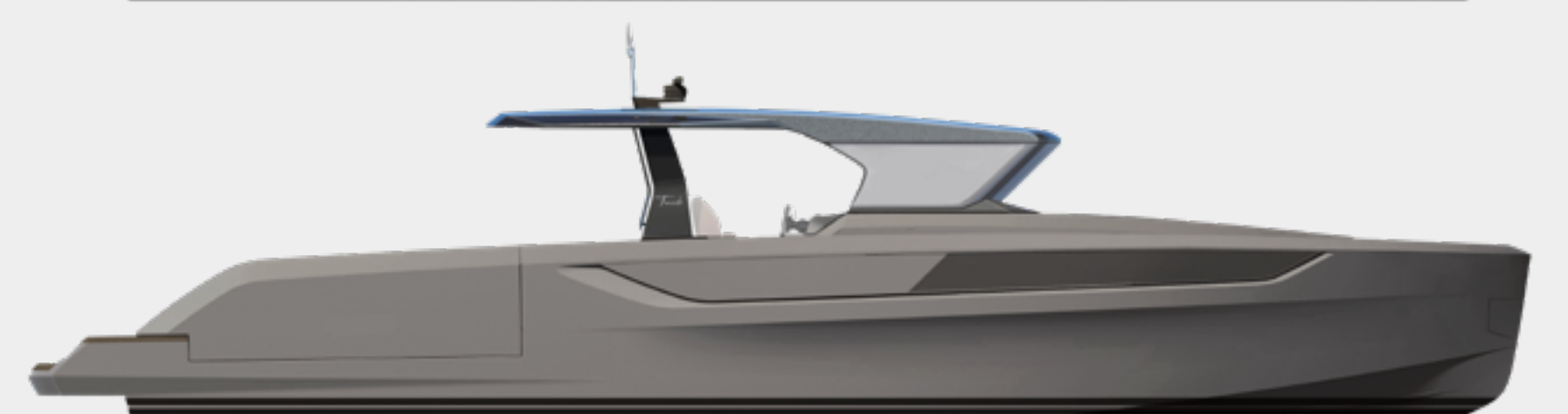
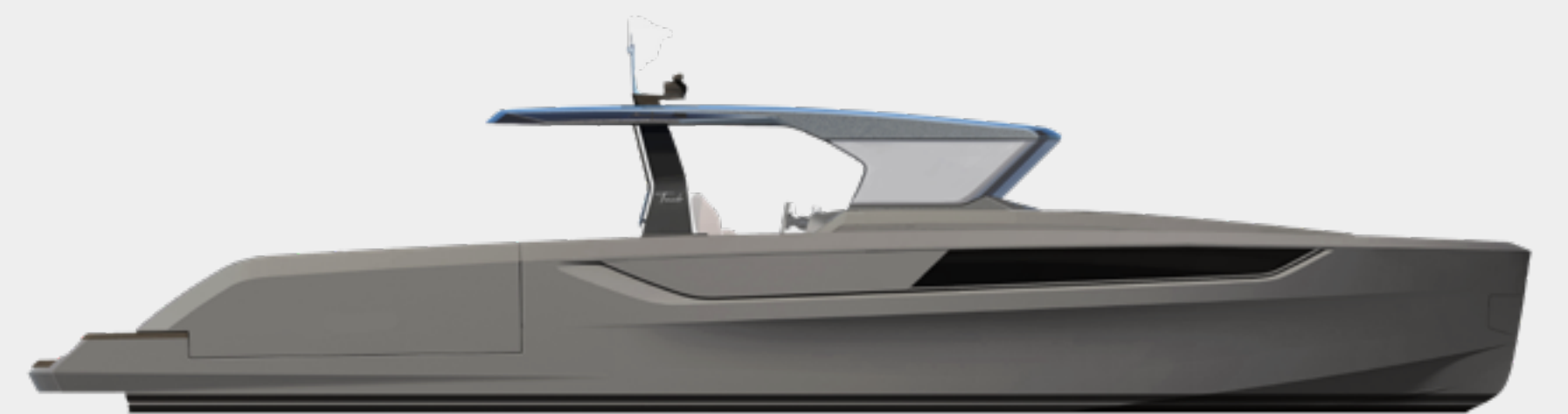
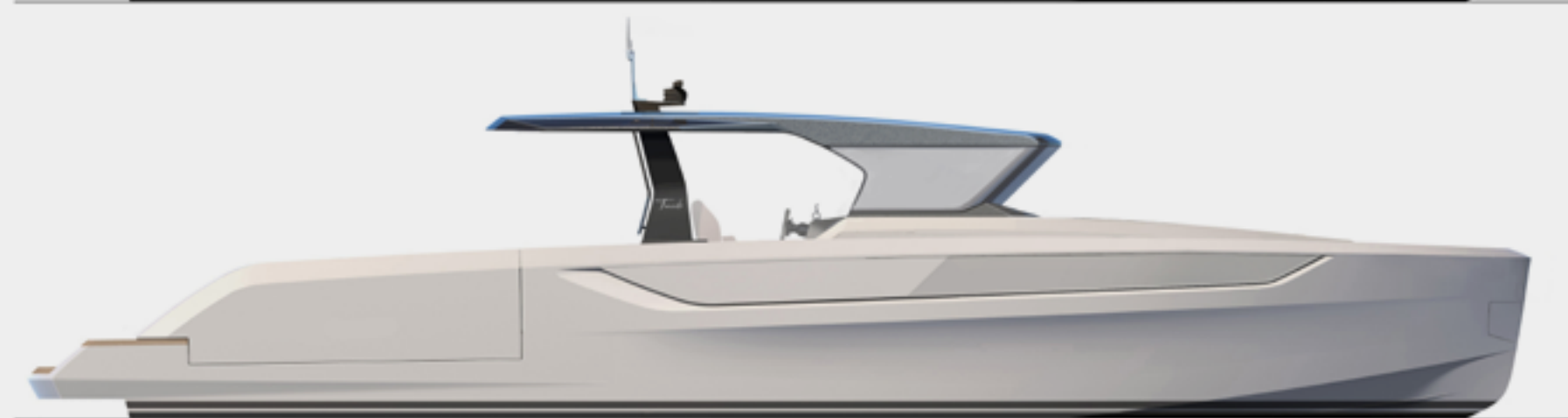

LONGITUDINAL SECTION

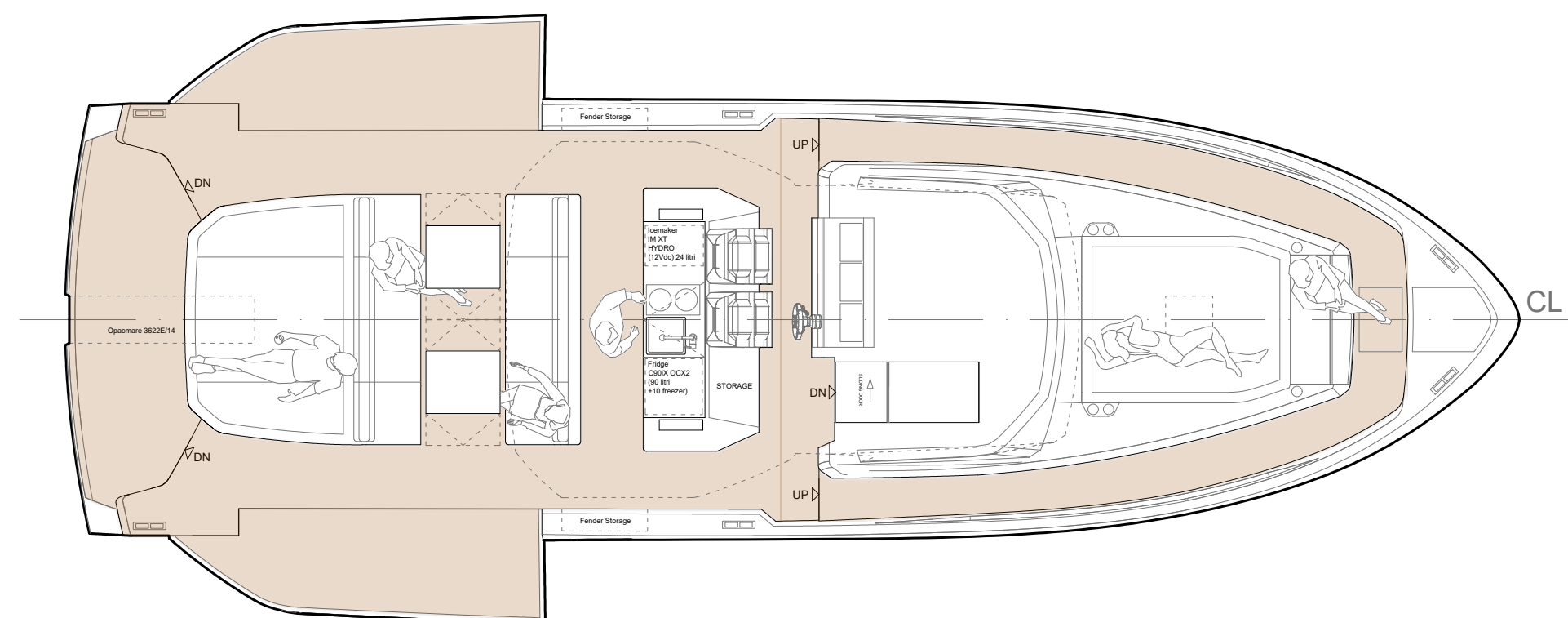

MAIN DECK

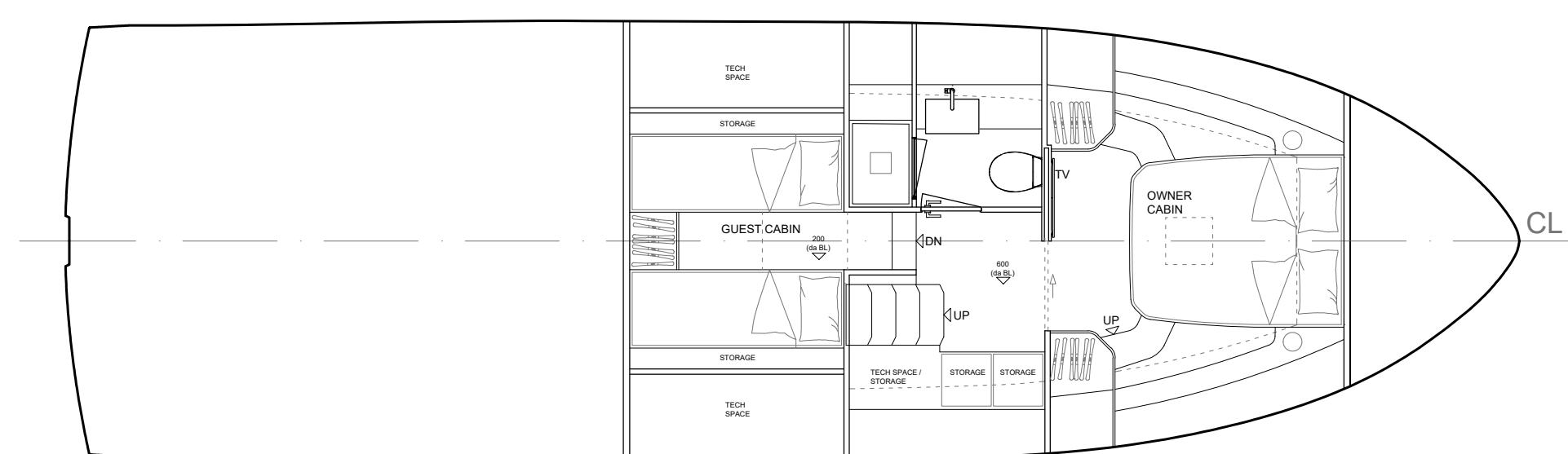

LOWER DECK

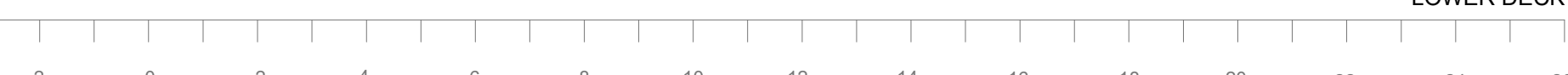

TUXEDO 13.88

Technical Data

BUILDER	DESIGN	ENGINEERING	HULL AND SUPERSTRUCTURE
Tuxedo Yachting House srl	Luca Dini Design Agon	Studio NAMES	Light Alloy 5083
CLASS CEERTIFICATE	LOA	BEAM	DRAFT
RINA - CE Cat B	44.90 feet 13,88 m	13.80 feet 4,20 m	3.38 feet 1 m
DISPLACEMENT LIGHT SHIP	FUEL CAPACITY	FRESH WATER CAPACITY	BLACK WATER CAPACITY
25.350 lb 11,5 tons	343gal US 1300 lt	132gal US 500 lt	30gal US 113,5 lt
ANCHOR			
1 x 15 Kg chain 50 m Ø8			

Inboard

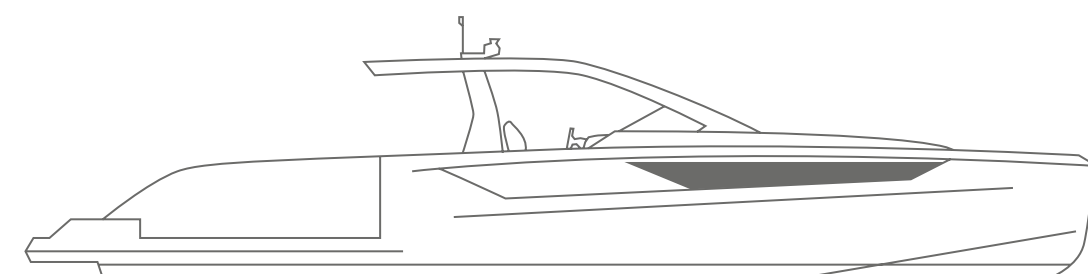

Outboard

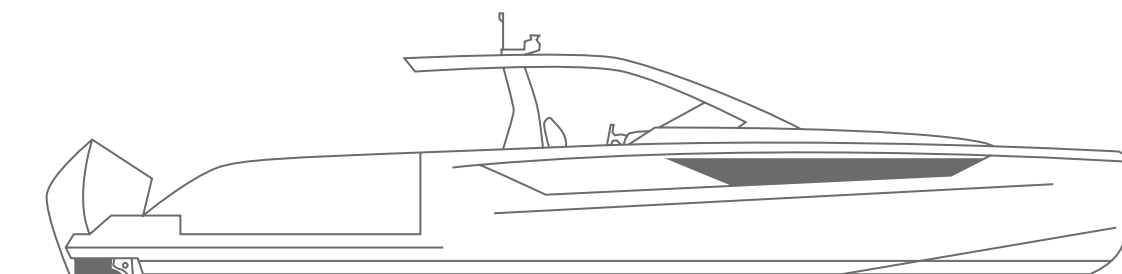

2 X Volvo Penta D6 IPS 650 (480 hp) STD	STANDARD ENGINES OPT 1	3 x Mercury Verado 300 hp
2 x Man xxxxxxxx with Hybrid Package	STANDARD ENGINES OPT 2	2 x Man xxxxxxxx with Hybrid Package
37/40	MAX SPEED	40
33/35	CRUISING SPEED	35
2 X Volvo Penta D8 IPS 700 (550 hp) OPT	OPTIONAL ENGINES OPT 1	3 x Mercury Racing 450R (450 hp)
2 x Man xxxxxxxx with Hybrid Package	OPTIONAL ENGINES OPT 2	
43	MAX SPEED	46
38	CRUISING SPEED	40

TUXEDO 13.88

Hull and Deck

Hull made of light alloy 5083 and thermal and acoustic insulation.



DECK

Deck, platform in teak
Stainless steel handrails on port and starboard side
Stainless steel handrails on control panel
Electric access to engine room
Companionway in fumè Plexiglass & stainless steel
Bow sunbathing mattress in Silvertex
Floating armchairs
Cockpit table with an electric lifting system
Standard fixed platform IPS version only
Outdoor shower with hot and cold water
Shore power
Fuel and Water tank refill acces
Retractable alluminium bollard
Flip-open bulwark
Bathing ladder manually extractable

T-TOP

T-Top in black color
2 white Led lights in the centre
8 extra led lights (opt)
Aft awning with poles (opt)
Bow awning with poles (opt)

CONTROL PANEL

Double backrest
Cup holders near the steering wheel
Footstool
Windshield
USB Socket

GALLEY

Outdoor galley color white
2 Induction cooktops
1 stainless steel sink
2 fridges with satin stainless steel door

OPTIONAL ON REQUEST

1 BBQ
1 drawer fridge under seat bench
1 Ice maker / Coffee machine

TUXEDO 13.88

Interior Layout

Interior finish is provided in oak.
Any other finish is available as an option.
The lighting is designed with led with dimmer control.

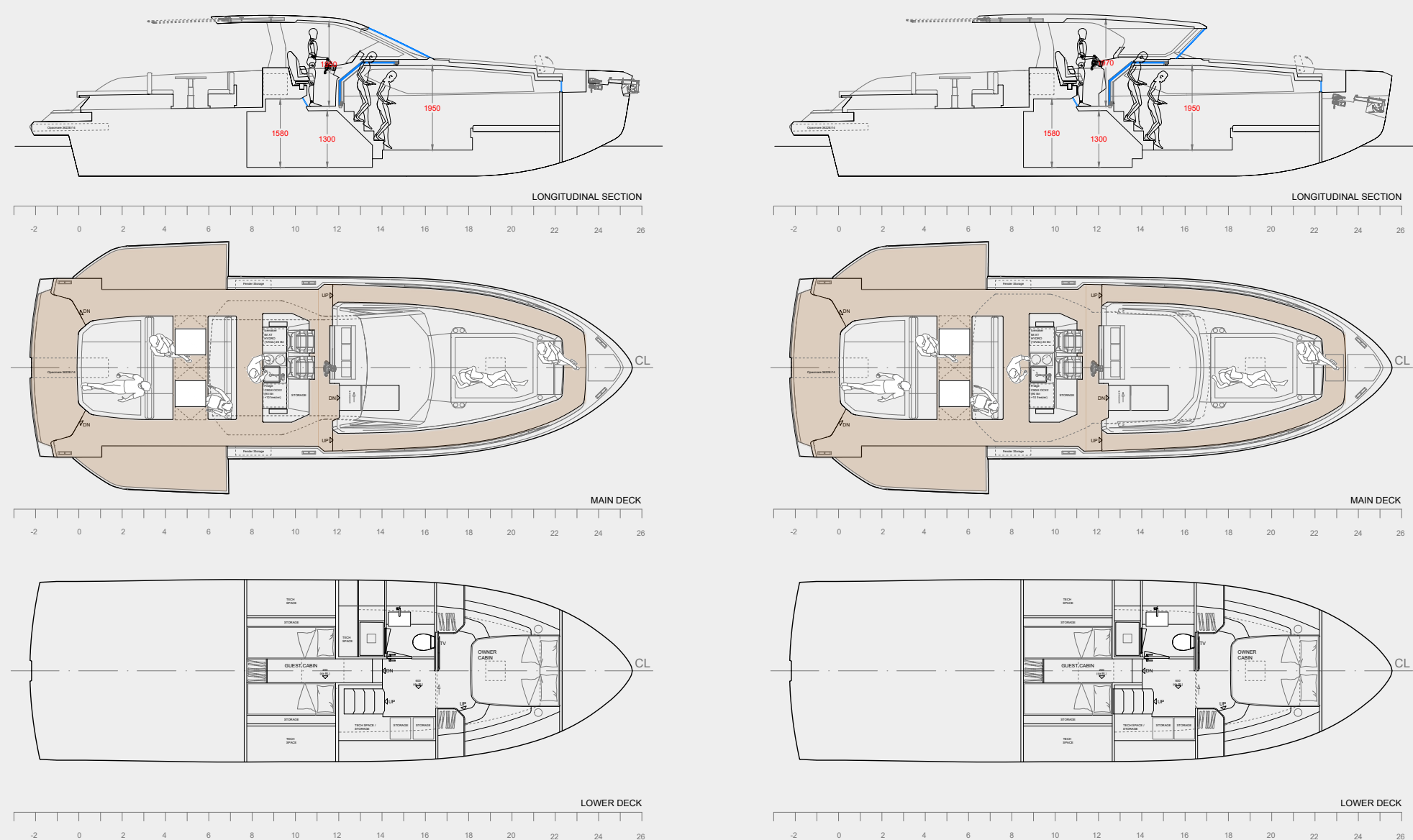

MAIN CABIN

Large berth (1.60 X 2.00 m)

Lockers and large drawer

1 main closet

Niches beside bed

1 opening hatch (opt)

2 side windows

Bedhead led lights

USB socket

A/C and heating system (opt)

Led lighting with dimmer control

HEAD

Electric toilet with fresh water

Ceramic sink

Mirror, Locker & Shelf

Electric drain pump

Shower box

1 opening side windows

Shower door in Plexiglass

Led lighting with dimmer control

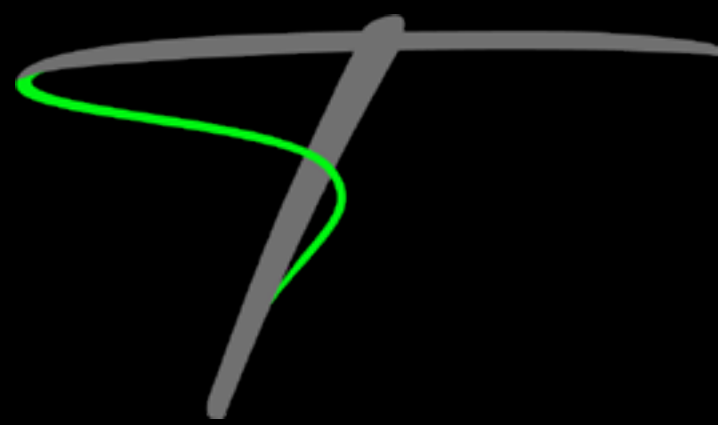

PRODUCTION SITES

TUXEDO YACHTING HOUSE SRL

Via Dei Devoto, 197a
16033 - Lavagna (GE)

sales@tuxedo-yachts.com
tuxedo-yachts.com

HEADQUARTER

TUXEDO YACHTING HOUSE SRL

Via G. Parini, 9
20121 - Milano (IT)

info@tuxedo-yachts.com
tuxedo-yachts.com